

Inspire is not automatically assigned to Okta dashboard. Please follow the below steps to add it to your Okta dashboard:

1. Open [OKTA dashboard](#).
2. Click **Add apps** option on the left-hand side of the screen.

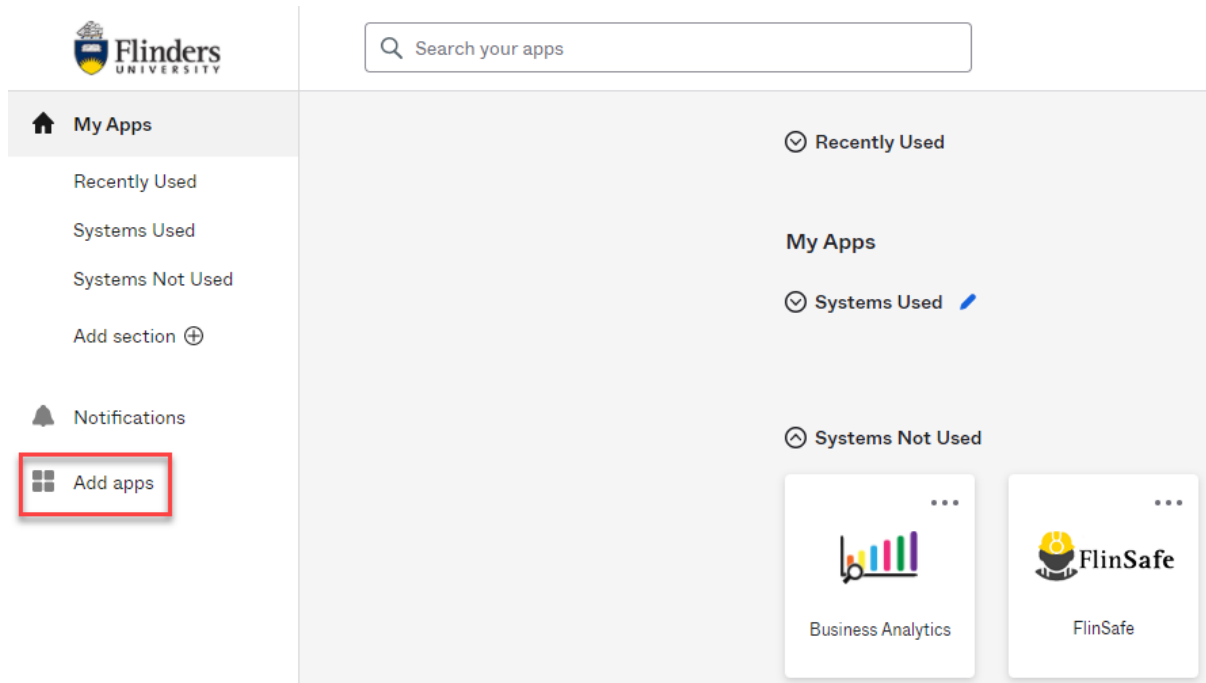

3. Type up 'ocf' in the **App Catalog** box.
4. You will see a message 'We couldn't find this app' and below a blue button **Add a bookmark instead**. Click on the blue button.

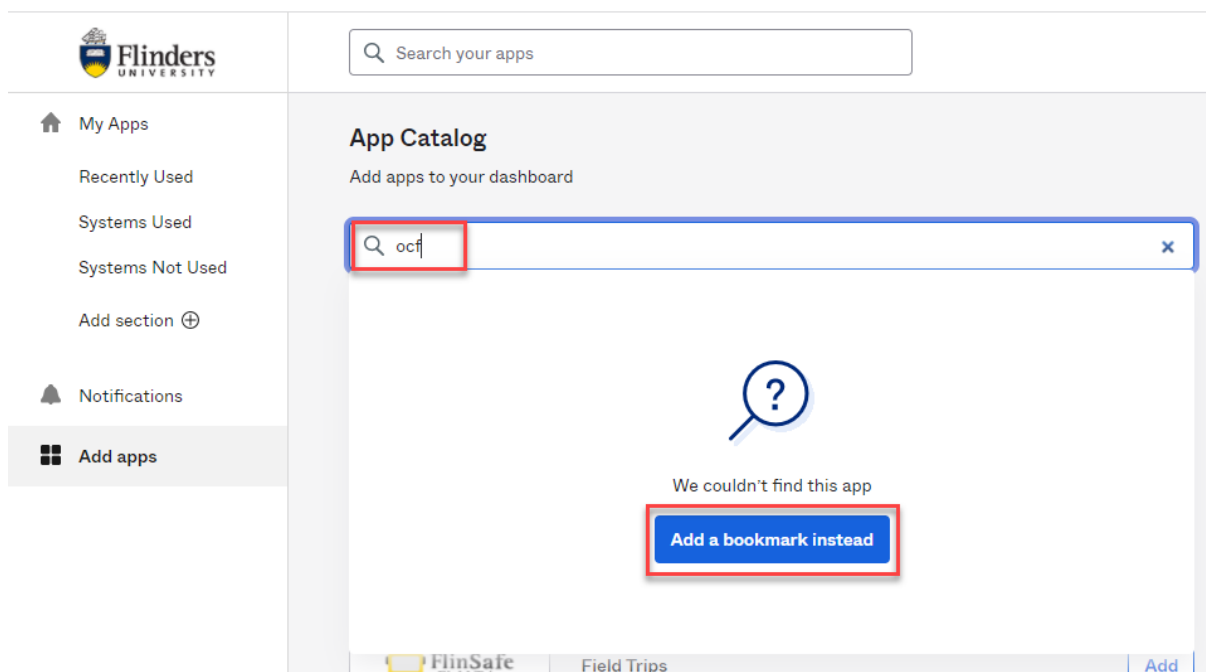

5. A new window **Add Bookmark** will open. Add the following information:

- **App URL:** <https://inspire.flinders.edu.au/flinders/saml/login>
- **App name:** Inspire.

6. Then click **Add bookmark**.

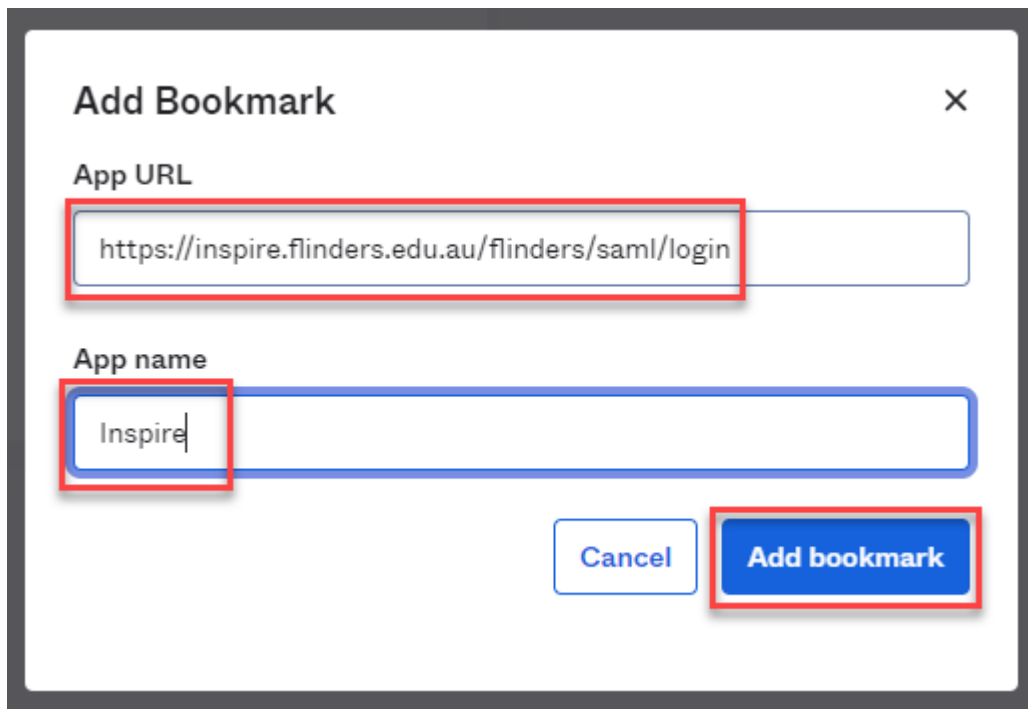

The screenshot shows a dialog box titled "Add Bookmark" with a close button (X) in the top right corner. It contains two input fields: "App URL" with the text "https://inspire.flinders.edu.au/flinders/saml/login" and "App name" with the text "Inspire". Below the fields are two buttons: "Cancel" and "Add bookmark". The "Add bookmark" button is highlighted with a red border.

7. Now you will see **Inspire** added to your Okta dashboard.

8. Click the Inspire chiclet to access the system.

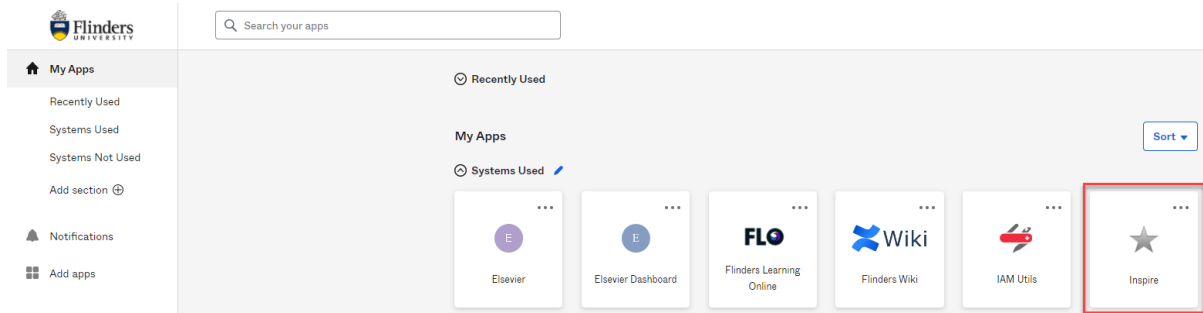

Please visit the [Inspire](#) webpage for more information about the system.